

PLOT DATE: 6/19/2013 7:17 PM

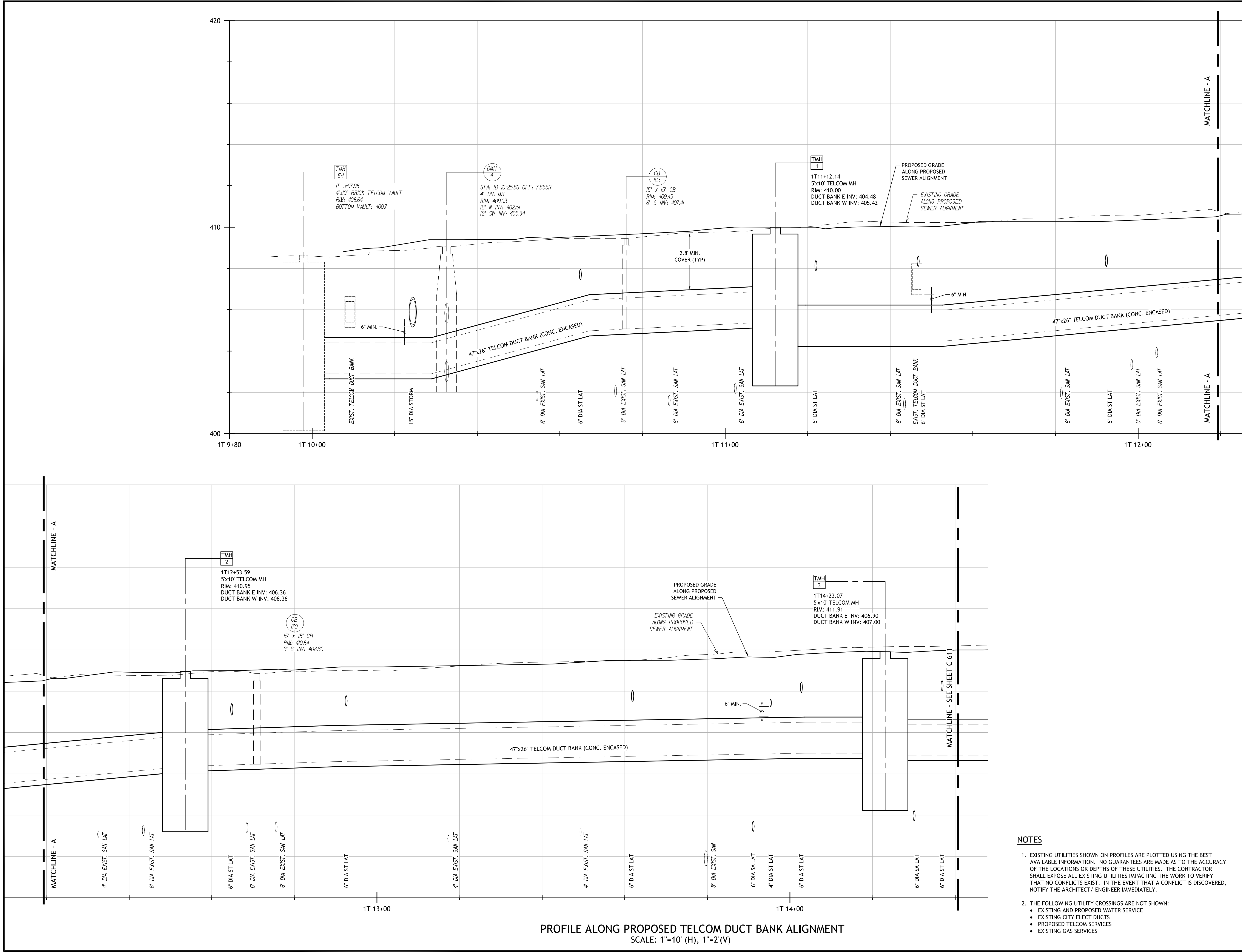

PROFILE ALONG PROPOSED TELCOM DUCT BANK ALIGNMENT
SCALE: 1"=10' (H), 1"=2'(V)

NOTES

- EXISTING UTILITIES SHOWN ON PROFILES ARE PLOTTED USING THE BEST AVAILABLE INFORMATION. NO GUARANTEES ARE MADE AS TO THE ACCURACY OF THE LOCATIONS OR DEPTHS OF THESE UTILITIES. THE CONTRACTOR SHALL EXPOSE ALL EXISTING UTILITIES IMPACTING THE WORK TO VERIFY THAT NO CONFLICTS EXIST. IN THE EVENT THAT A CONFLICT IS DISCOVERED, NOTIFY THE ARCHITECT / ENGINEER IMMEDIATELY.
- THE FOLLOWING UTILITY CROSSINGS ARE NOT SHOWN:
 - EXISTING AND PROPOSED WATER SERVICE
 - EXISTING CITY ELECT DUCTS
 - PROPOSED TELCOM SERVICES
 - EXISTING GAS SERVICES

SASAKI
64 Pleasant Street, Watertown, Massachusetts 02472 USA
t 617 926 3300 f 617 924 2748 w www.sasaki.com

ABELLA
Associates, P.C.
Relationships. Resources. Results.

www.labellapc.com
300 STATE STREET
ROCHESTER, NY 14614
P: (585) 454-6110
F: (585) 454-3066

Engineering
Architecture
Environmental
Planning

No.	Description	Date
DWG ISSUE & REVISION HISTORY		

Stamp

Key Plan

Project Title:

**ITHACA COMMONS
REPAIR & UPGRADE -
Utility PACKAGE**
Ithaca, New York

Drawing Title:

**UTILITY PROFILES
TELCOM**

Project No. 06682.00 Scale: AS NOTED
Drawn By: JRE/MHB
Checked By: JWM
Approved By: JWM
Date: 6-18-13

Drawing No. **C 610**

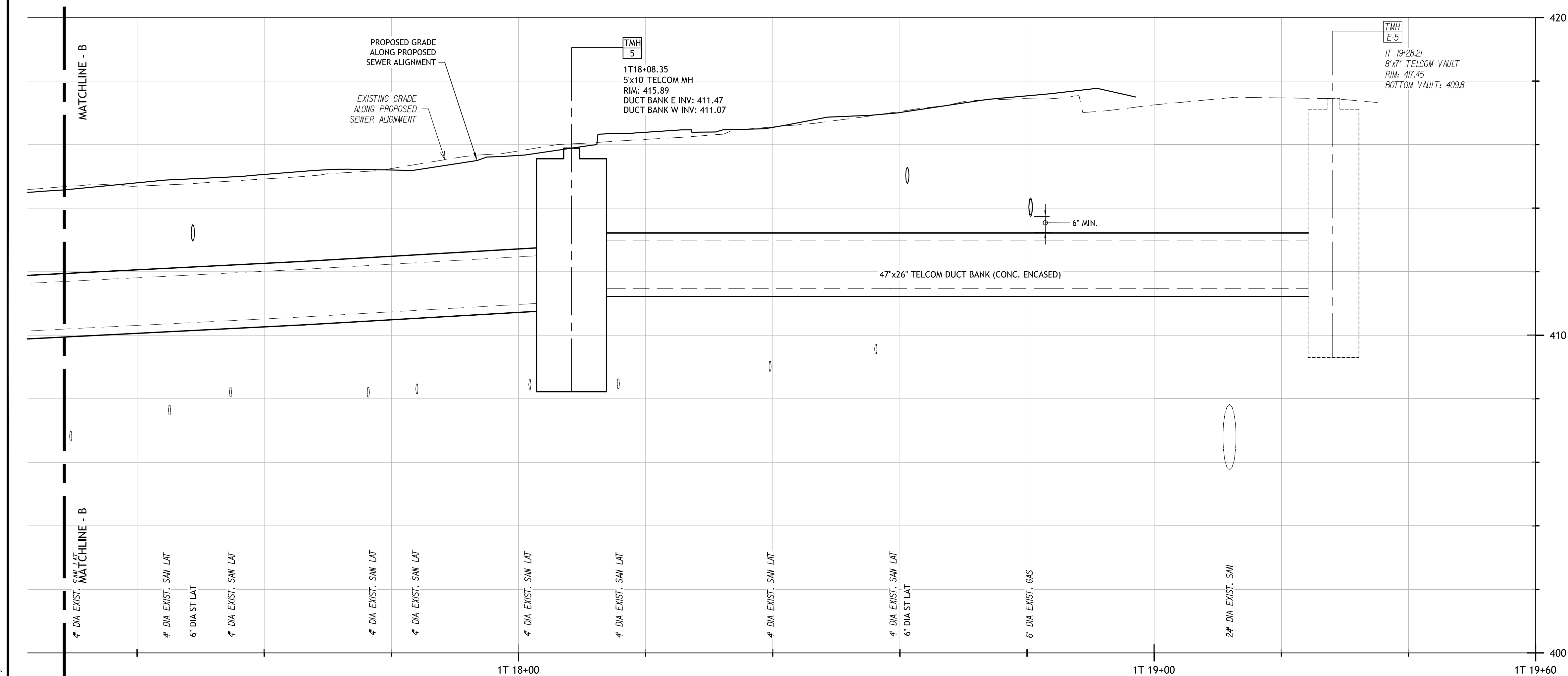
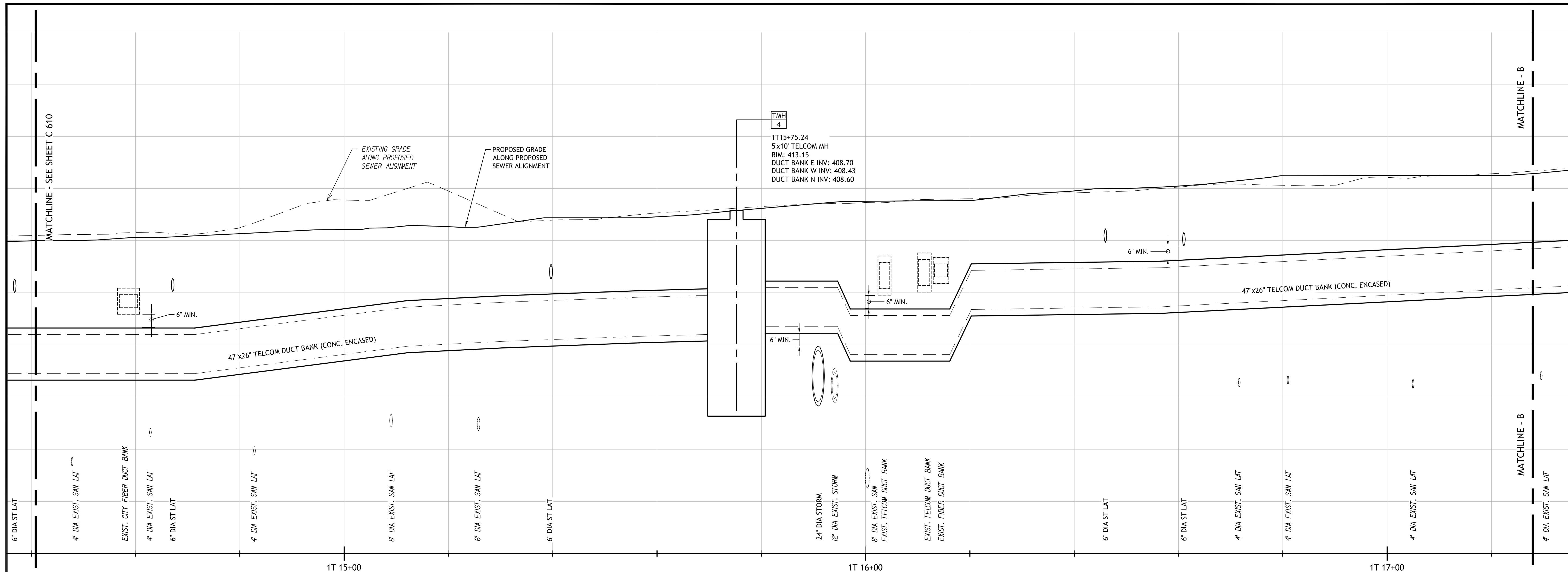

PROFILE ALONG PROPOSED TELCOM DUCT BANK ALIGNMENT
SCALE: 1"=10' (H), 1"=2'(V)

NOTES

1. EXISTING UTILITIES SHOWN ON PROFILES ARE PLOTTED USING THE BEST AVAILABLE INFORMATION. NO GUARANTEES ARE MADE AS TO THE ACCURACY OF THE LOCATIONS OR DEPTHS OF THESE UTILITIES. THE CONTRACTOR SHALL EXPOSE ALL EXISTING UTILITIES IMPACTING THE WORK TO VERIFY THAT NO CONFLICTS EXIST. IN THE EVENT THAT A CONFLICT IS DISCOVERED, NOTIFY THE ARCHITECT/ ENGINEER IMMEDIATELY.
2. THE FOLLOWING UTILITY CROSSINGS ARE NOT SHOWN:
 - EXISTING AND PROPOSED WATER SERVICE
 - EXISTING CITY ELECT DUCTS
 - PROPOSED TELCO/COM SERVICES
 - EXISTING GAS SERVICES

No.	Description	Date
-----	-------------	------

DWG ISSUE & REVISION HISTORY	
1	1

Stamp



Key Plan

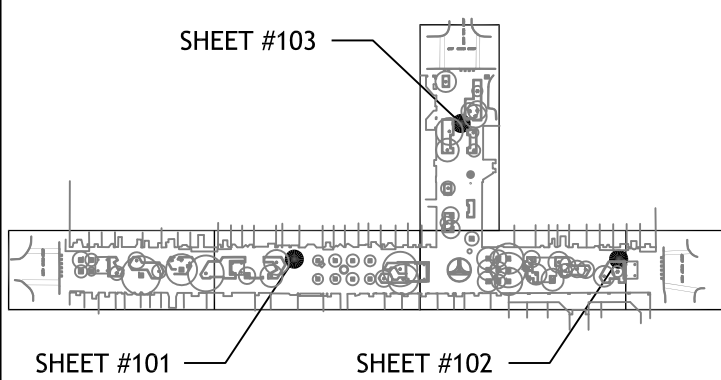

Project Title:

ITHACA COMMONS
REPAIR & UPGRADE -
Utility PACKAGE
Ithaca, New York

Drawing Title:

UTILITY PROFILES
TELCOM

Project No. 06682.00 Scale: AS NOTED

Drawn By: JRE

Checked By: JWM

Approved By: JWM
Date: 6-18-13

Drawing No.

C 611

PLOT DATE: 6/19/2013 7:18 PM

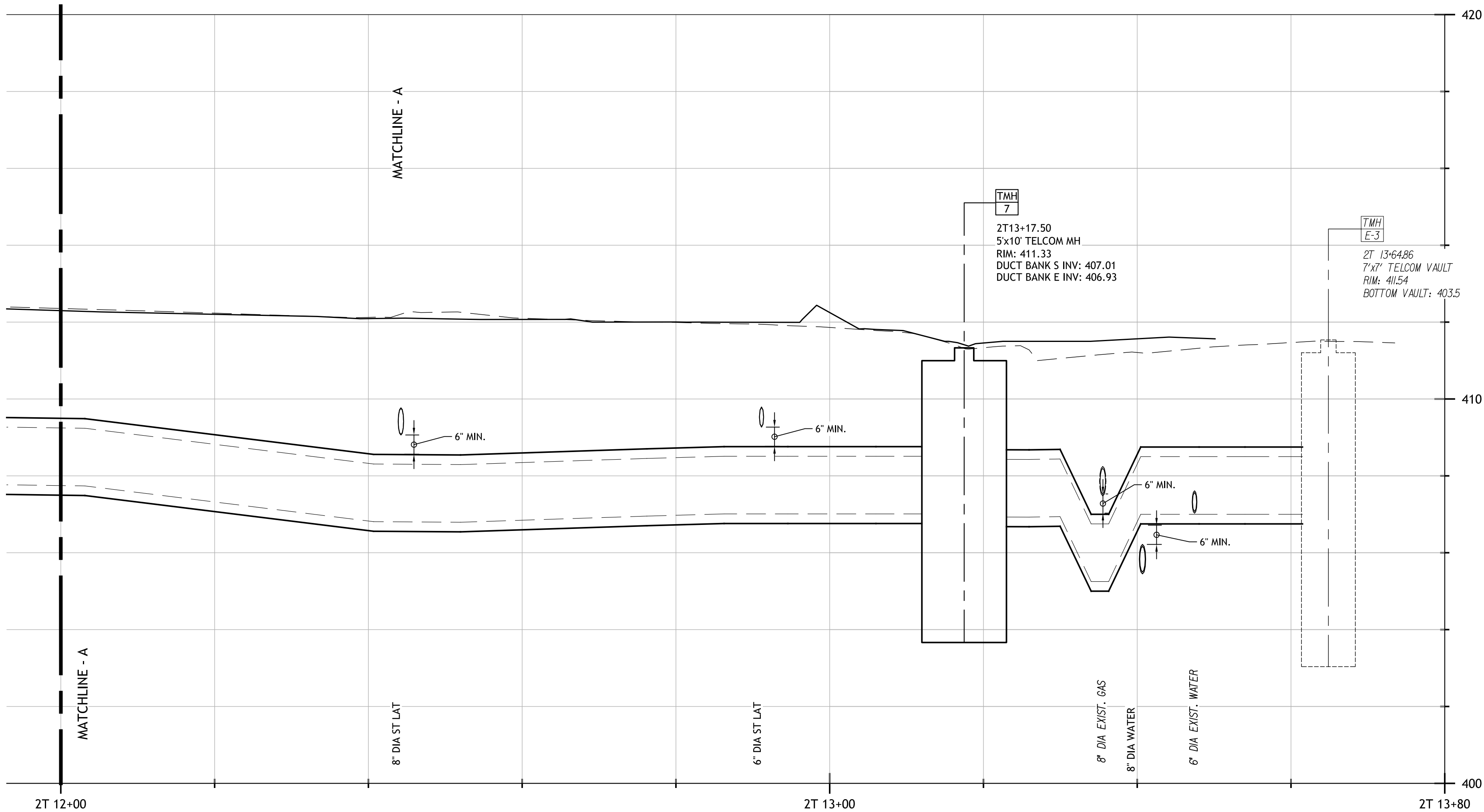
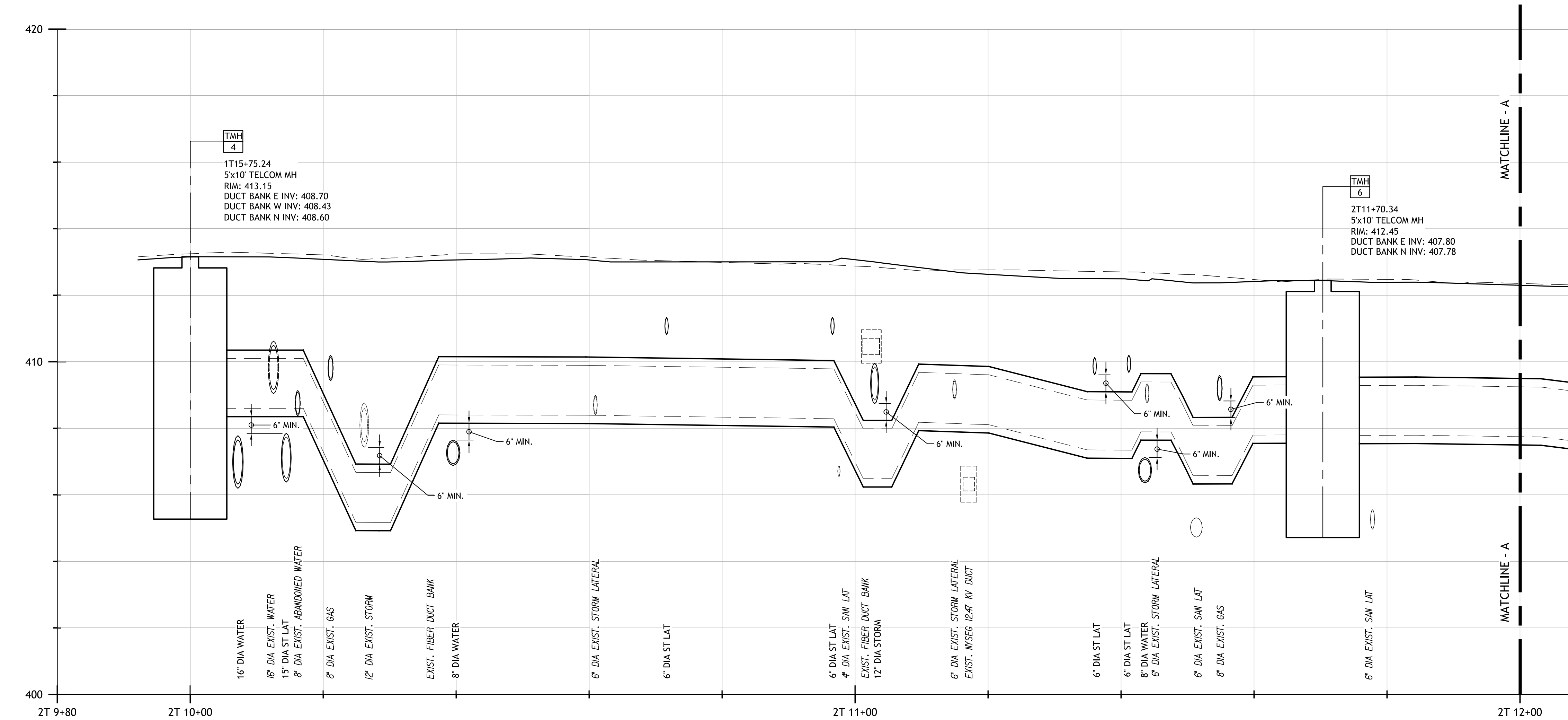

PROFILE ALONG PROPOSED TELCOM DUCT BANK ALIGNMENT - NORTH TIOGA ST.
SCALE: 1"=10' (H), 1"=2' (V)

NOTES

- EXISTING UTILITIES SHOWN ON PROFILES ARE PLOTTED USING THE BEST AVAILABLE INFORMATION. NO GUARANTEES ARE MADE AS TO THE ACCURACY OF THE LOCATIONS OR DEPTHS OF THESE UTILITIES. THE CONTRACTOR SHALL EXPOSE ALL EXISTING UTILITIES IMPACTING THE WORK TO VERIFY THAT NO CONFLICTS EXIST. IN THE EVENT THAT A CONFLICT IS DISCOVERED, NOTIFY THE ARCHITECT / ENGINEER IMMEDIATELY.
- THE FOLLOWING UTILITY CROSSINGS ARE NOT SHOWN:
 - EXISTING AND PROPOSED WATER SERVICE
 - EXISTING CITY ELECT DUCTS
 - PROPOSED TELCOM SERVICES
 - EXISTING GAS SERVICES

S A S A K I

64 Pleasant Street, Watertown, Massachusetts 02472 USA
t 617 926 3300 f 617 924 2748 w www.sasaki.com

ABELLA
Associates, P.C.

Relationships. Resources. Results.

www.labelapc.com
300 STATE STREET
ROCHESTER, NY 14614
P: (585) 454-6110
F: (585) 454-3066

Engineering
Architecture
Environmental
Planning

No.	Description	Date
-----	-------------	------

DWG ISSUE & REVISION HISTORY

Stamp



Key Plan

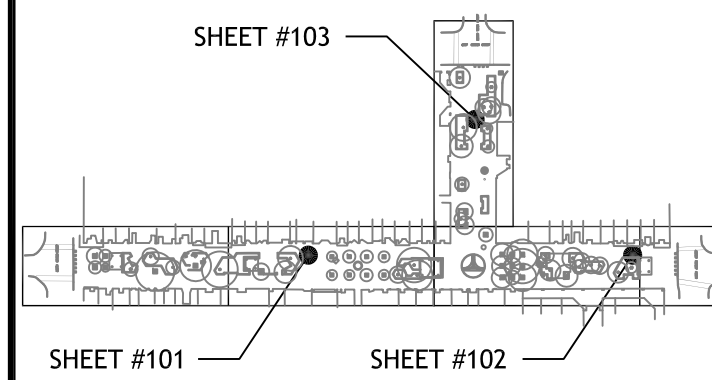

Project Title:

**ITHACA COMMONS
REPAIR & UPGRADE -
Utility PACKAGE**
Ithaca, New York

Drawing Title:

**UTILITY PROFILES
TELCOM**

Project No. 06682.00 Scale: AS NOTED

Drawn By: JRE

Checked By: JWM

Approved By: JWM

Date: 6-18-13

Drawing No.

C 612