

What is a Mat Foundation?

A Mat Foundation is essentially a holistic approach to total building support. It provides the most simple foundation systems as used by the Egyptians to support the pyramids or a gravity dam. It is a single footing that will be below street level that is 3 feet thick, 20,000 SF comprising 2,300 CY of concrete. The footing relies on its contiguous construction and gravity to tie the whole building substructure. It is composed of 3 simple steps; dig a big hole, set concrete reinforcing as designed by the New York State registered engineer in the hole and then fill said hole with 3 feet of concrete continuously until the pour is done. It should be noted that the foundation consists of all natural ingredients of steel and concrete made of fired limestone, sand, natural qualified and graded aggregate and pure Finger Lakes water and will be installed using best practices for sustainable construction.

See attached illustration.

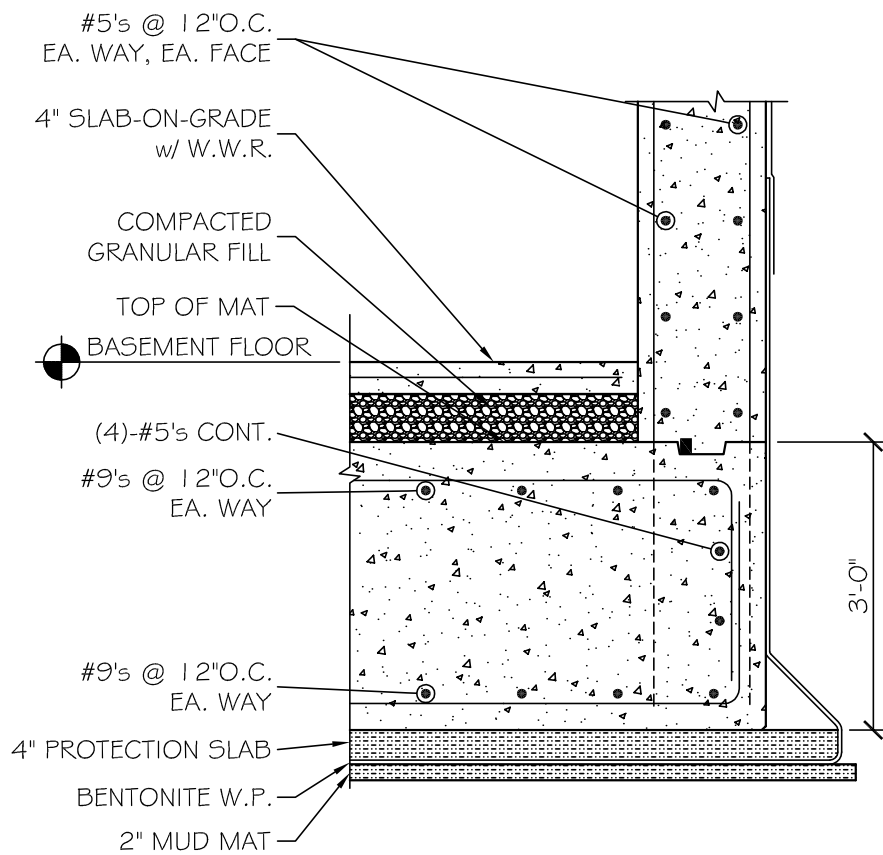

MAT FOUNDATION DETAIL